

T type

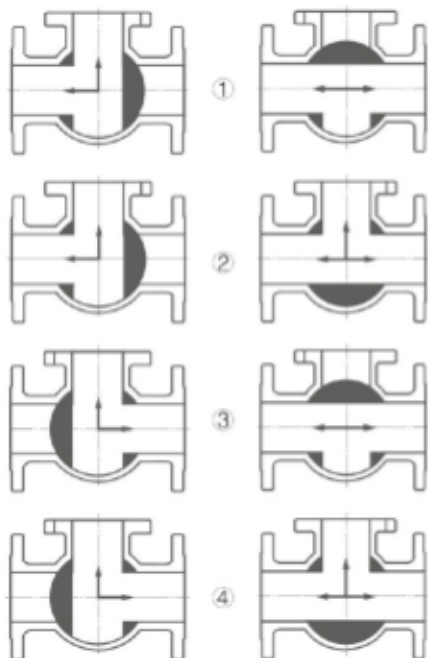

Function:

Three-way ball valves are used for switch over, mix and divide the flow of corrosive or noncorrosive liquid, gas or powdery mediums. Upon opening and closing, the smooth flow channel loss less pressure effects, making operation quite labor-saving and maintenance fairly easy. The five types of flow direction (figure on the right, 1 for L-shaped and 4 for T-shaped) to meet different technological requirements. It can be hand, air and electrically operated.

Structural features:

- 1、 Valve seat can be designed into four-side seated float ball and fixed ball, with smooth fluid state and reliable seal;
- 2、 The structure may be designed into side installed type and top installed type, with two ways seal, no, series flow upon switchover of flow direction;
- 3、 Anti-flyout design of valve stem;
- 4、 Antistatic design;
- 5、 Two-position (ON and OFF) lockup design.

L type

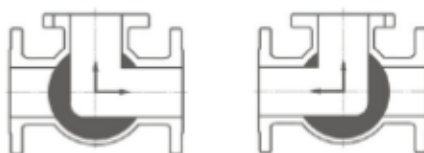

3-Way ball valve manufacture norms

Standards	API Series
Design standards	ANSI B 16.34
Pressure/Temperature rating	ANSI B 16.34
Face to face dimensions	ASME B 16.10
Flange ends	ASME B 16.5 GB/T 9113
Inspection and test	API598

Structural drawing (side entry floating type explosion drawing)

No.	Name of part
1	Bonnet
2	Nut
3	Bolt
4	Gasket
5	Seat ring1
6	Ball
7	Seat ring2
8	Body
9	Seat ring3
10	Seat ring4
11	Seat
12	O-ring
13	Insert plug
14	Stem
15	Stem washer
16	Stem packing
17	Gland screw
18	Gland
19	Stop plate
20	Snap ring
21	Lever

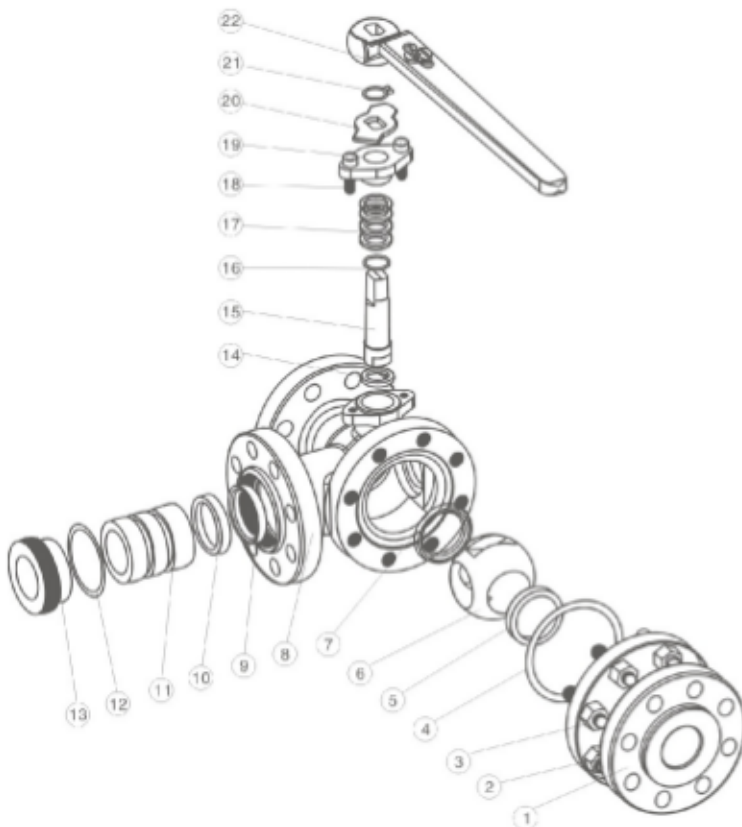

Three way ball valve

Structural drawing(top entry floating type)

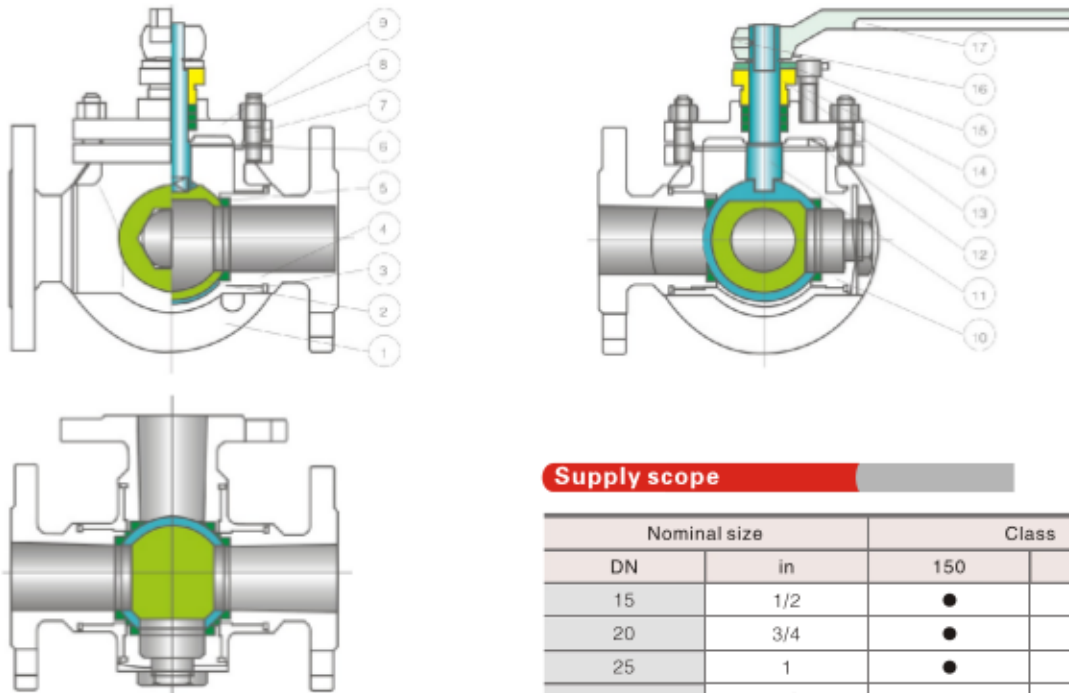

No.	Name of part	No.	Name of part
1	Body	10	Seat retainer
2	Ball	11	Stem
3	O-ring	12	Stem packing
4	Adapter	13	Packing gland
5	Seat ring	14	Stop screw
6	Gasket	15	Stop plate
7	Bolt	16	Set screw
8	Nut	17	Lever
9	Bonnet		

Supply scope

Nominal size		Class	
DN	in	150	300
15	1/2	●	●
20	3/4	●	●
25	1	●	●
32	1 1/4	●	●
40	1 1/2	●	●
50	2	●	●
65	2 1/2	●	●
80	3	●	●
100	4	●	●
125	5	●	●
150	6	☆	☆
200	8	☆	☆
250	10	☆	☆

Note: ● stands for handle operated valves;

☆ stands for gearbox operated valves;

- stands for no option of this.

Those not covered in the table can be custom made to users' requirements.

Main parts materials(side entry type)

No.	Name of part	Material			No.	Name of part	Material		
		Carbon steel	Stainless steel	Low temperature steel			Carbon steel	Stainless steel	Low temperature steel
1	Bonnet	A216 WCB	A351 CF8M	A352 LCB	12	O-ring	Viton		
2	Nut	A194 2H	A194 8	A194 4	13	Insert plug	A105+ENP	A182 F316	A350 LF3
3	Bolt	A193 B7	A193 B8	A320 L7	14	Stem	A182 F6a	A182 F316	A182 F316
4	Gasket	Flexible graphite+SS			15	Gasket	PTFE/RPTFE		
5	Seat ring	PTFE/RPTFE			16	Stem packing	PTFE/Flexible graphite		
6	Ball	A105+ENP	A182 F316/A351 CF8M	A350 LF3/A352 LCB	17	Screw	A193 B7	A193 B8	A320 L7
7	Seat ring	PTFE/RPTFE			18	Packing gland	A216 WCB	A351 CF8M	A352 LCB
8	Body	A216 ENP	A351 CF8M	A352 LCB	19	Stop plate	A105+ENP		
9	Seat ring	PTFE/RPTFE			20	Snap ring	65Mn		
10	Seat ring	PTFE/RPTFE			21	Lever	Q235A		
11	Seat retainer	A105+ENP	A182 F316	A350 LF3					

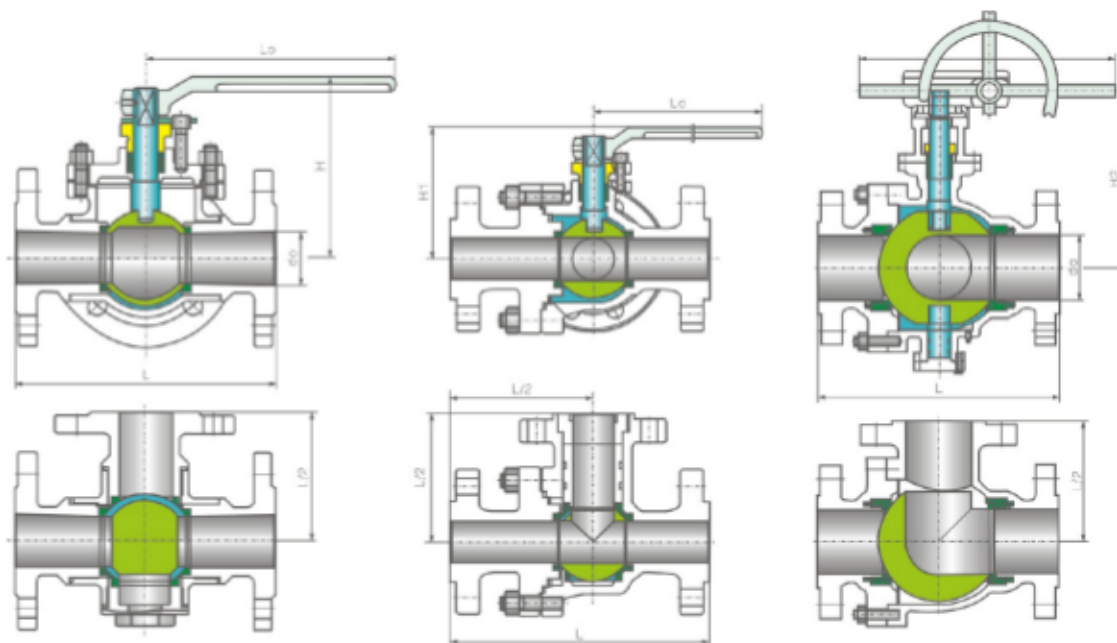

Main outline dimensions class 150

mm

DN	NPS	L	do	H	H1	H2	Lo	W	Weight(kg)
15	1/2	140	13	90	70	/	160	/	3
20	3/4	150	15	106	86	/	230	/	4
25	1	160	25	109	88	/	230	/	6
32	1 1/4	/	32	125	106	/	400	/	10
40	1 1/2	210	38	149	132	/	400	/	14
50	2	220	51	154	137	/	400	/	20
65	2 1/2	250	64	189	162	/	700	/	25
80	3	260	76	198	170	/	700	/	32
100	4	330	102	254	229	/	1050	/	45
125	5	430	127	273	247	/	1050	/	/
150	6	510	152	/	/	314	/	450	/
200	8	580	203	/	/	430	/	600	/
250	10	670	250	/	/	475	/	600	/

Main outline dimensions class 300

mm

DN	NPS	L	do	H	H1	H2	Lo	W	Weight(kg)	
									PN2.5	PN4.0
15	1/2	140	13	90	70	/	160	/	3	3
20	3/4	150	15	106	86	/	230	/	4	4
25	1	160	25	109	88	/	230	/	6.5	6.5
32	1 1/4	/	32	125	106	/	400	/	11	11
40	1 1/2	210	38	149	132	/	400	/	15	15
50	2	220	51	154	137	/	400	/	21.5	21.5
65	2 1/2	250	64	189	162	/	700	/	/	/
80	3	260	76	198	170	/	700	/	35	35
100	4	330	102	254	229	/	1050	/	49	49
125	5	430	127	273	247	/	1050	/	/	/
150	6	510	152	/	/	314	/	450	/	/
200	8	580	203	/	/	430	/	600	/	/
250	10	670	250	/	/	475	/	600	/	/